

Emergency Downlight

Self-contained emergency LED downlight for cut outs 47 - 85mm with battery supply for 3 hour emergency lighting, change between Manual- (IEC 60598-2-22) and SelfTest(Autotest)(IEC 62034) by dip switch on site, supplied with a set of changeable optics for escape route (ESC) and antipanic (ENT) lighting, available accessory: surface mount box. Lifetime: 50.000hrs @L70, non-maintained operation mode, battery: LiFePO4 3,2V 1,6Ah, initial charging period: 24 hours. Dimensions: Ø95 x 36 mm, weight: 0.19 kg.

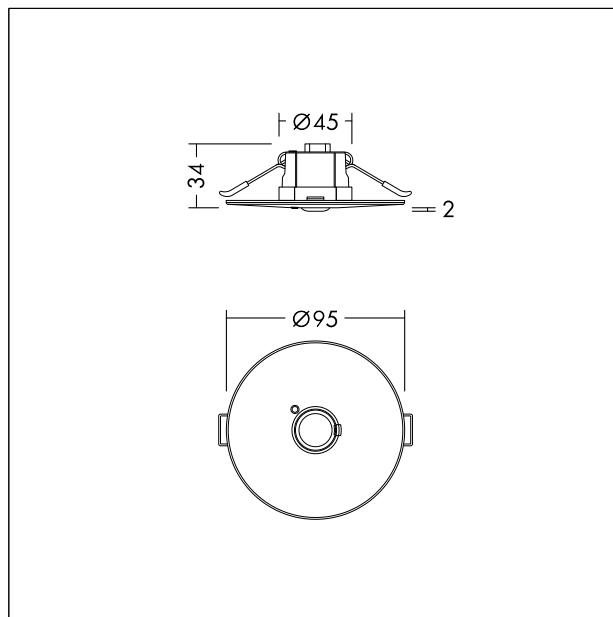

TE_IRIS_F_EA19_E3_E3T_Front_2692.jpg



TE_IRIS_M_IRIS_EA19_E3_E3T.wmf

Light Distribution

STD - standard

All values marked with an * are rated values. Connected electrical load and luminous flux are subject to an initial tolerance of +/- 10%, the most similar colour temperature is subject to an initial tolerance of +/- 150K. Unless stated otherwise, the values apply to an ambient temperature of 25°C.